

CERMET RESISTOR

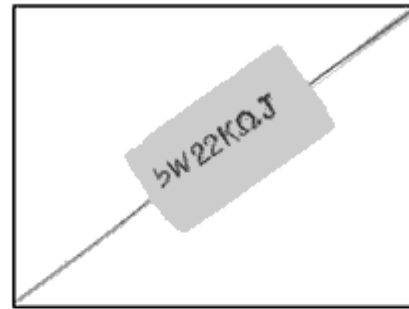

Pb free



CERMET RESISTOR AXIAL

WATT	DIMENSIONS [mm]			
	L	W	H	d
2 W	18 ±1.0	7.0 ±1.0	7.0 ±1.0	0.6 ±0.1
3 W	22 ±1.0	8.0 ±1.0	8.0 ±1.0	0.8 ±0.1
5 W	22 ±1.0	9.5 ±1.0	9.5 ±1.0	0.8 ±0.1
7 W	35 ±1.5	9.5 ±1.0	9.5 ±1.0	0.8 ±0.1
10 W	48 ±1.5	9.5 ±1.0	9.5 ±1.0	0.8 ±0.1
15 W	48 ±1.5	13 ±1.2	13 ±1.2	0.8 ±0.1
20 W	60 ±2.0	13 ±1.2	13 ±1.2	0.8 ±0.1
30 W	75 ±2.5	19 ±1.2	17 ±1.2	0.8 ±0.1
40 W	89 ±2.5	19 ±1.2	19 ±1.2	0.8 ±0.1

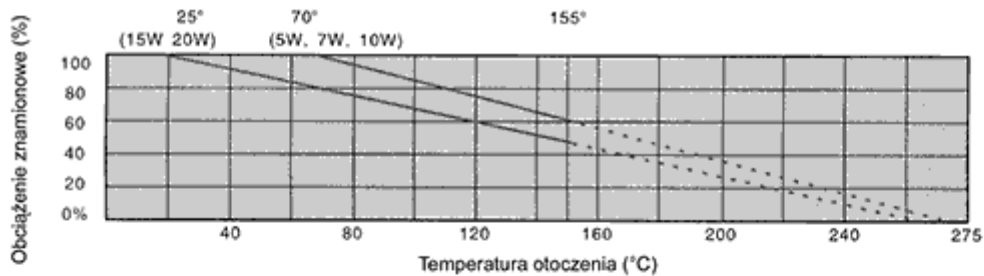
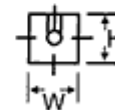
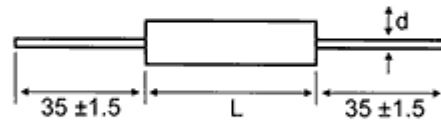

TEST ITEMS	CONDITION	SPEC.
Terminal Strength	Pull with 4.5kg	Can withstand
Solder ability of Terminal	230°C, 3 sec, dipping	not less than 3/4
Heat Resistance	350°C, 3.5 sec	±(2% + 0.05Ω)
Resistor Body Strength	10kg, 10 sekund	Can withstand
Dielectric Strength	1000V, 1 min applied	±(0.5% + 0.05Ω)
Insulation Resistance	500V megger	1000MΩ
Rated Load Characteristic	rated voltage -30 min.	±2%
Short-Time Overload	2.5 times of RCWV for 5 secs	±(2% + 0.05Ω)
Resistance Temp. Coeff.	-30°C ~ 155°C	±50 ~ 800 PPM/°C
Moisture-Proof Load Life	40°C, 95% RH, 1.5 hrs On, 0.5 hrs Off, for 1000 hrs	±(5% + 0.05Ω)
Load Life	70°C at rated power, 1.5 hrs On, 0.5 hrs Off, for 1000 hrs	±(5% + 0.05Ω)
Temp. Cycling	-30°C / +85°C for 5 cycles	±(1% + 0.05Ω)

RCWV: Rated Continuous Working Voltage