

Listwy szpilkowe jednorzędowe RM 2.00mm

Dane techniczne:	
Max napięcie pracy	500Vac/1min
Max prąd pracy	1,5A
Rezystancja kontaktu	< 20mΩ/100mA DC
Rezystancja izolatora	> 10 ¹² Ω/ 500 V DC
Tworzywo obudowy	Poliamid UL94V-0
Materiał kontaktu	fosforobraz
Powierzchnia kontaktu	Gold Flash
Temperatura pracy	-45 - +105 ⁰ C



proste

PHS40G-2.00 = PLMS 40 = ZSL-40G-2.00

Symbol	l. pinów
PLMS 40	1* 40
PLMS 40SMT1	1* 40
PLMS 40SMT2	1* 40

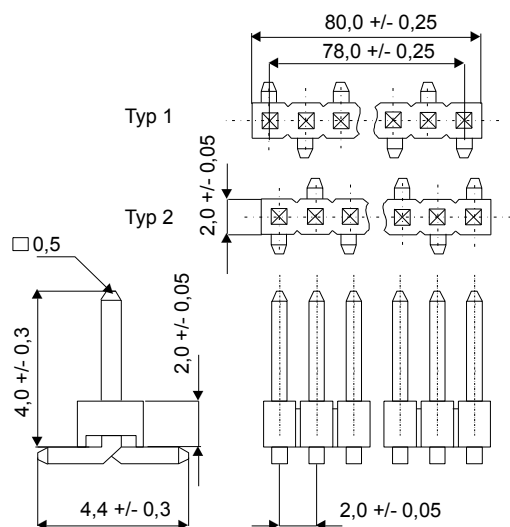
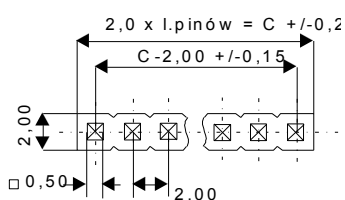
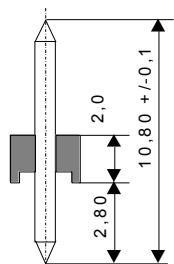

katowe

PHS40W-2.00 = PLMS 40W = ZSL-40G-2.00

Symbol	l. pinów
PLMS 40W	1* 40
PLMS 40WSMT	1* 40

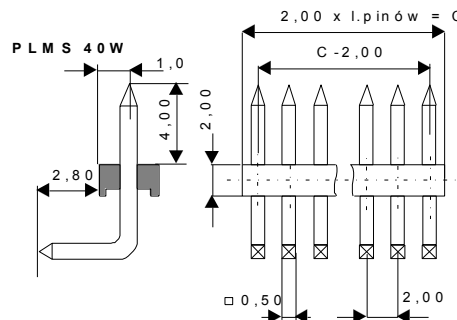
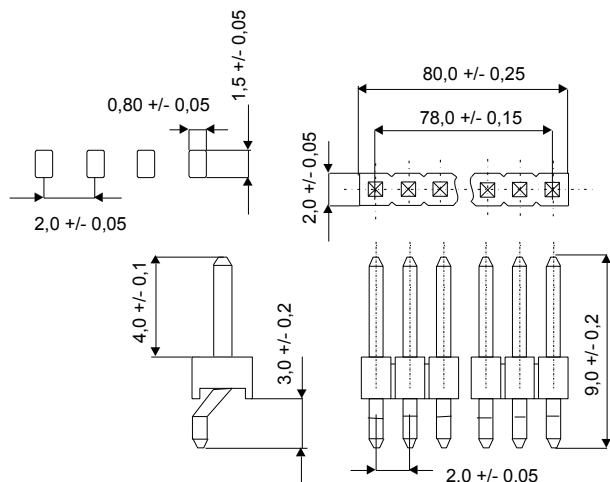

Listwy szpilkowe dwurzędowe RM 2.00mm

proste

PHD80G-2.00 = PLMD 80 = ZSL-80/2G-2.00

Symbol 1. pinów
PLMD 80 2* 40
PLMD 80SMT1 2* 40
PLMD 80SMT2 2* 40

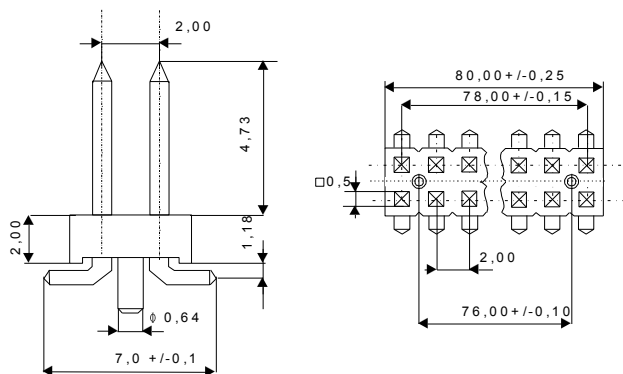
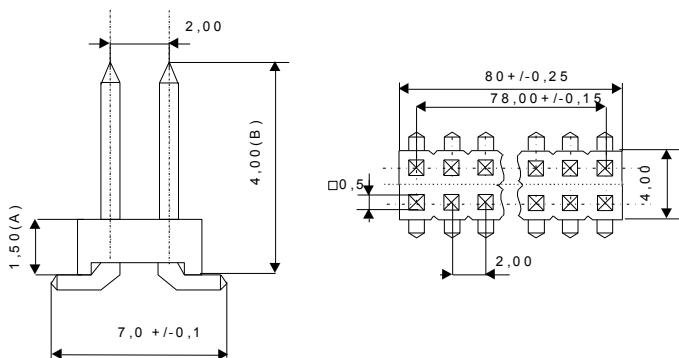
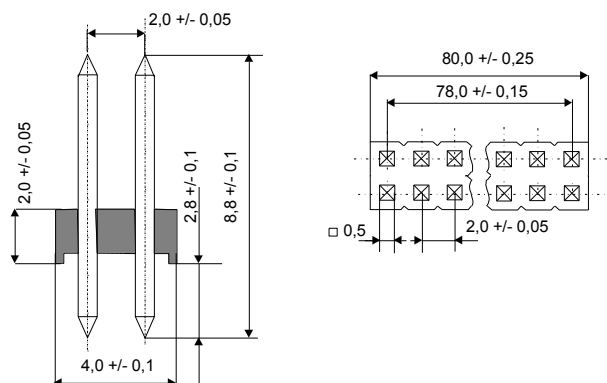

katowe

PHD80W-2.00 = PLMD 80W = ZSL-80/2W-2.00

Symbol 1. pinów
PLMD 80W 2* 40
PLMD 80WSMT 2* 40

